

DEPARTS FROM Ft. FRANCES



Granite Lake Outpost

Fish: Walleye and Northern Pike

Lake Size: 4,511 acres

GPS Coordinates: N 50 27 6.5 / W 89 45 0.8

210 Air Miles from our base in Ft. Frances

Granite Lake is located within the southern boundary of Wabakimi Provincial Park. With its ideal structure for both walleye and northern pike it produces trophy-size fish every year



Features

- 1,280 sq ft fully insulated cabin with large rake windows
- Three bedrooms - sleeps up to 8
- Large deck (320 sq ft)
- Huge Screened-in-porch
- Hot and cold running water
- Indoor washroom with shower, sink and hot/cold water
- Four 14 ft Lund boats all equipped with 9.9 four stroke Yamaha motors
- Gas for boats supplied
- Two portable padded swivel seats with backs per boat
- Landing nets, minnow buckets, paddles and cushions for each boat
- Solar powered lights
- Two propane refrigerators for maximum storage and ice production.
- Propane range
- Cookware and all utensils
- Fully stocked pantry
- Propane BBQ grill
- Propane fish cooker/fryer
- Fish cleaning houses with running water
- Wood stove with an ample wood supply to keep you cozy

Granite Lake Stats

- Fish: Walleye and Northern Pike
- Lake Size: 4,511 acres
- GPS Coordinates: N 50 27 6.5 / W 89 45 0.8
- 240 Air Miles from our base in Ft. Frances
- Water Clarity: Dark Tea-Stained

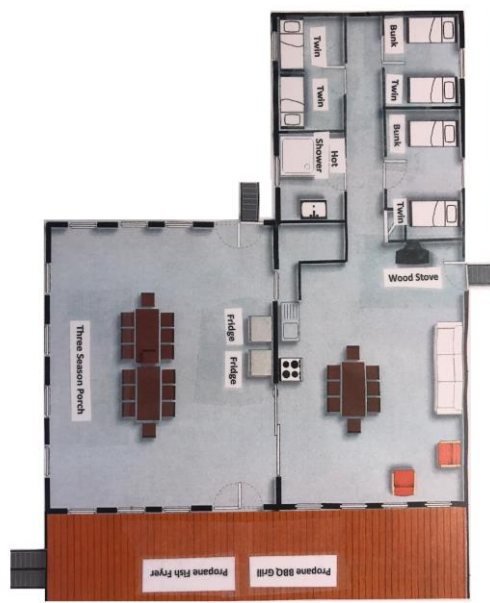

866-707-7637

Rustymyers.com

GRANITE LAKE

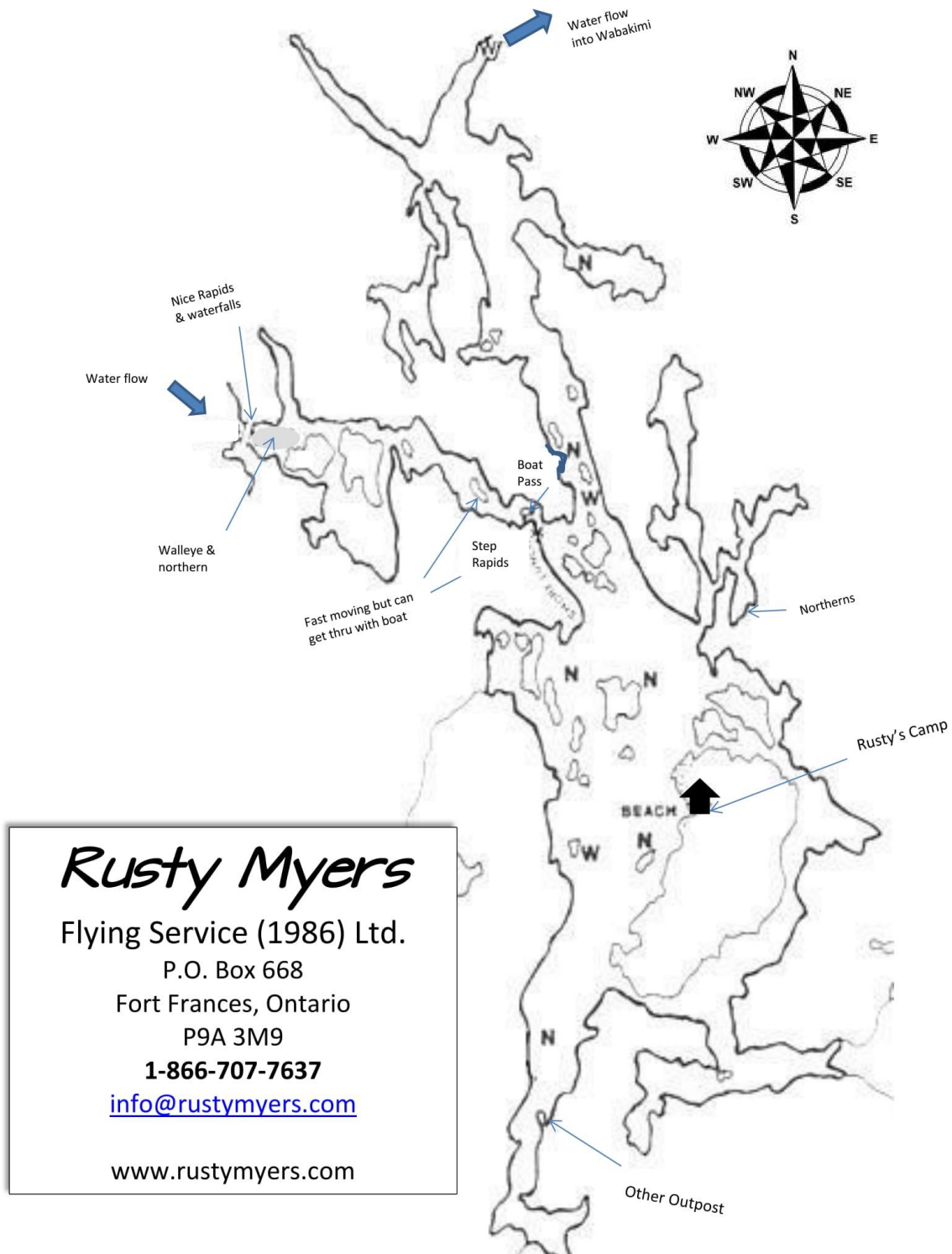

Rusty Myers

Flying Service (1986) Ltd.

P.O. Box 668

Fort Frances, Ontario

P9A 3M9

1-866-707-7637

info@rustymyers.com

www.rustymyers.com

866-707-7637

Rustymyers.com